

Narthex Core Project Design Notes

The Narthex Core Project design retains the elements that had the strongest support in the congregation. It will open up the Narthex/ Hallway/ Courtyard space, and it will make the Courtyard a space that is much more practical to use. The accessible bathrooms are important to the parents of young kids and our beloved seniors.

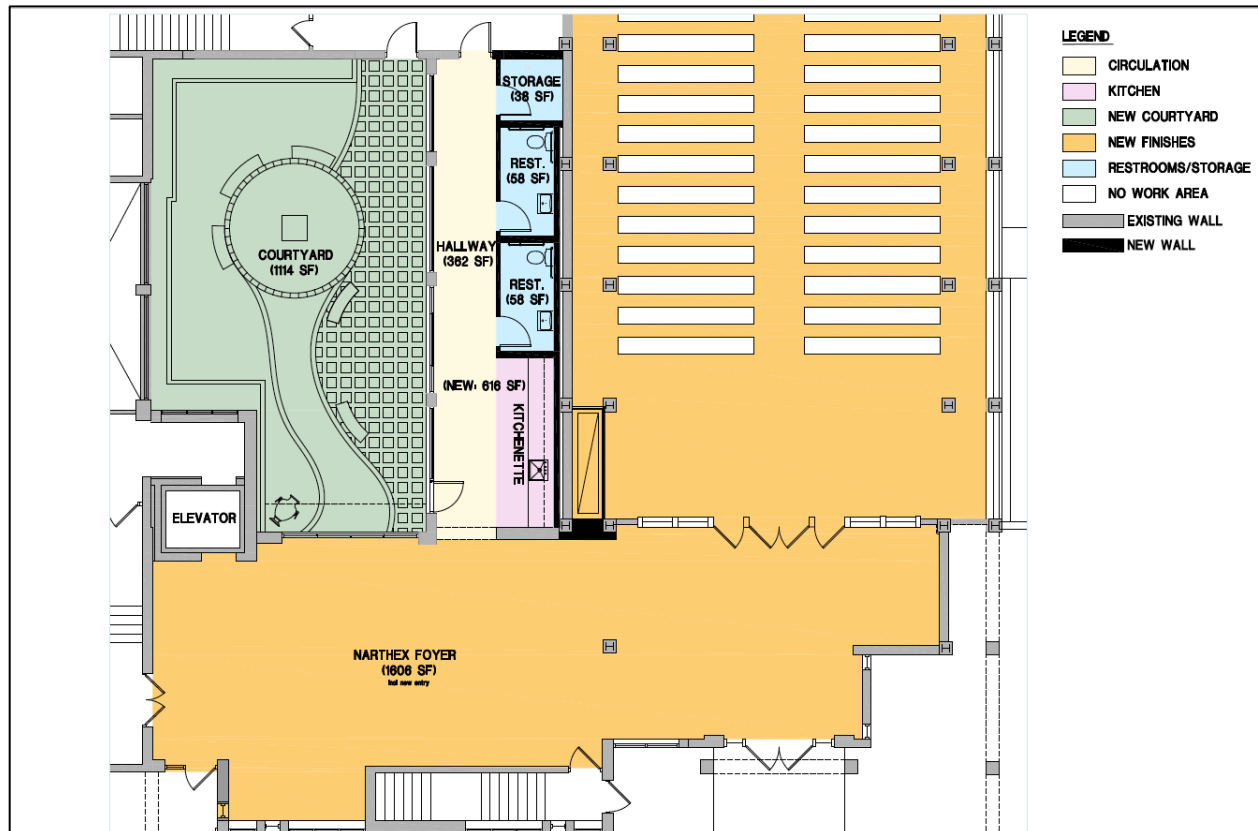

- **Narthex Core Project Overall Design**
 - This project accomplishes the core centerpiece of the previously proposed Narthex Renovation: a new hallway with easily accessible bathrooms and kitchenette, and a courtyard that is better suited for events
 - This project does not preclude St. Mark's from building additional elements of the original plan in the future.
- **Hallway**
 - The new design allows for new amenities that are convenient to the Narthex, Courtyard, and Sanctuary: two bathrooms, a storage room, and the kitchenette.
 - The windows in the Hallway onto the Courtyard will make it an inviting, well-lighted space with a connection to the outdoors.

- Access to the Courtyard from the Narthex is moved to the new Hallway door across from the Kitchenette.
- The new Hallway makes access to the Education Wing easier from the Narthex, especially during inclement weather or when the Education Wing front entrance may be locked.
- **Bathrooms**
 - The bathrooms may make it possible for some people to come to church who attend less frequently now, because they need easy access to bathrooms.
 - Easy access to bathrooms from the Sanctuary is important for our youngest members and parents, and some of our seniors.
 - The bathrooms are gender-neutral, and ADA-compliant for those with mobility issues.
- **Sanctuary.** One of the concerns by many members about the original project was the intrusion into the Sanctuary space.
 - This design eliminates any changes within the Sanctuary except a bump out in the back left side wall for an air shaft to provide ventilation to the hallway and bathrooms.
 - Members have now experienced how the church feels during regular services with space at the back, and the use of chairs in the back for larger events.
 - Since COVID-19 struck, many members have a different sense of how crowded or empty the Sanctuary feels for a given number of attendees.
- **Courtyard**
 - The revised Courtyard, with easy access to the Narthex and hallway, creates opportunities for different kinds of events. Some events could use both the Courtyard and Narthex space, and the ready access to bathrooms and the kitchenette widens our options.
 - The revised Courtyard provides an option for small worship gatherings such as Easter vigil, devotions, and prayer gatherings.
 - We have more fellowship options with the new Courtyard. The hardscaped terrace can allow for stand-up fellowship, table setup, and seating.
 - The new Courtyard reduces maintenance of grass and plantings.
 - As we grow into the vision for the use of the space, the use of some non-structural shade devices (shade sails, canopies, pergolas) could help make this a more inviting space when we don't want direct sunlight.
- **Not included** – some difficult decisions have been made by the Council to keep costs within our reach. We can revisit these priorities in the future and continue to look for innovative solutions to meet the changing needs of the Congregation.

- Handicapped Parking – the Council worked with the architect to evaluate a less expensive approach for handicapped parking, but that work is about \$300K beyond the amount we think we can afford, so there will be no changes to our parking situation at this time.
- Sanctuary Refurbishment – several items were marked as lower priorities by our members, including refurbishing pews and floors. relocating left side door, utilizing space at back of sanctuary for a nursery and meeting room.